

# ECO GBS 93

## Product information

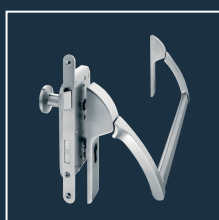

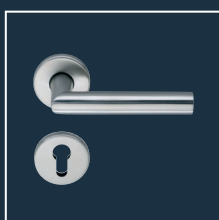
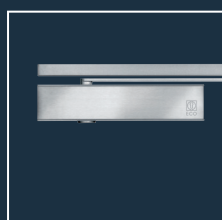

### ■ SYSTEM TECHNOLOGY FOR THE DOOR



**GBS 93**

**Product characteristics**

Lock type	PZ-72 W (W = handle / knob execution)	■
Backset	55	■
	65	■
	80	■
	100	■
Panic function	B	■
	D	■
	E	■
Face plate	Stainless steel	■
Face plate width	20	■
	24	■
Hub	9 mm	■
Suitable for the use on fire- and smoke control doors	<b>F</b>	■
Tested acc. EN / DIN	<b>EN 179</b>  <b>EN 1125</b> 	

■ Yes    - No    □ On request

**Description**

- Panic mortise lock for double leaf doors.
- Suitable for fire-protection doors
- Tested and certified acc. to **EN 179** and **EN 1125**
- Made completely of fire-resistant materials
- Extras: interrogation of dead bolt position
- Related counter lock for passive leaf: GBS 94 on page 462.

On request individual plate stamping possible at extra charge.

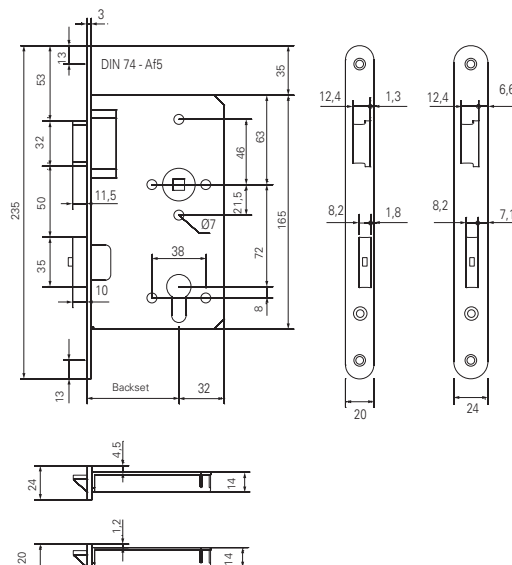

**GBS 93 ■ Panic mortise lock for double-leaf fire-proof doors**



EN 179 

EN 1125 

**F**

**Panic function B**

PZ-72	Face plate	Backset		Article number
Rebated door Face plate: 20 x 235 mm	round	55	L	2093aha02h33100
			R	2093aha02h33200
		65	L	2093aYes02h33100
			R	2093aYes02h33200
		80	L	2093ama02h33100
			R	2093ama02h33200
		100	L	2093aqa02h33100
			R	2093aqa02h33200

PZ-72	Face plate	Backset		Article number
Unrebated door Face plate: 24 x 235 mm	round	55	L	2093aha02m33100
			R	2093aha02m33200
		65	L	2093aYes02m33100
			R	2093aYes02m33200
		80	L	2093ama02m33100
			R	2093ama02m33200
		100	L	2093aqa02m33100
			R	2093aqa02m33200



EN 179 

EN 1125 

**F**

**Panic function D**

PZ-72	Face plate	Backset		Article number
Rebated door Face plate: 20 x 235 mm	round	55	L	2093aha02h35100
			R	2093aha02h35200
		65	L	2093aYes02h35100
			R	2093aYes02h35200
		80	L	2093ama02h35100
			R	2093ama02h35200
		100	L	2093aqa02h35100
			R	2093aqa02h35200

PZ-72	Face plate	Backset		Article number
Unrebated door Face plate: 24 x 235 mm	round	55	L	2093aha02m35100
			R	2093aha02m35200
		65	L	2093aYes02m35100
			R	2093aYes02m35200
		80	L	2093ama02m35100
			R	2093ama02m35200
		100	L	2093aqa02m35100
			R	2093aqa02m35200



EN 179 

EN 1125 

**F**

**Panic function E**

PZ-72 W (W = handle / knob execution)	Face plate	Backset		Article number
Rebated door Face plate: 20 x 235 mm	round	55	L	2093aha02h34100
			R	2093aha02h34200
		65	L	2093aYes02h34100
			R	2093aYes02h34200
		80	L	2093ama02h34100
			R	2093ama02h34200
		100	L	2093aqa02h34100
			R	2093aqa02h34200

PZ-72 W (W = handle / knob execution)	Face plate	Backset		Article number
Unrebated door Face plate: 24 x 235 mm	round	55	L	2093aha02m34100
			R	2093aha02m34200
		65	L	2093aYes02m34100
			R	2093aYes02m34200
		80	L	2093ama02m34100
			R	2093ama02m34200
		100	L	2093aqa02m34100
			R	2093aqa02m34200

ECO Schulte GmbH & Co. KG  
Iserlohner Landstraße 89  
D - 58706 Menden

Telefon: +49 2373/9276-0  
Fax: +49 2373/9276-40

[info@eco-schulte.de](mailto:info@eco-schulte.de)  
[www.eco-schulte.de](http://www.eco-schulte.de)

© ECO Schulte GmbH & Co. KG - Änderungen vorbehalten  
© ECO Schulte GmbH & Co. KG - Subject to change